

# KLEBERG-RYLIE BRANCH LIBRARY

## Site & Location Plans

Set within an area of transition of rural to suburban uses, this relatively new branch could use additional landscaping and a highlighting of its entrance to enhance its civic image.



View of the entrance



View along the street

### FAST FACTS

**ADDRESS:**

1301 Edd Road, 75253

**PHONE/FAX:**

214-670-8471, fx 670-8474

**COUNCIL DISTRICT:**

Eight

**CURRENT FACILITY:**

Opened in 1995; 10,700 GSF

**ARCHITECT:**

Hastings, Treviño & Treviño

**'98/'99 MATERIALS:**

91,415 materials used

**COLLECTION SIZE:**

52,750

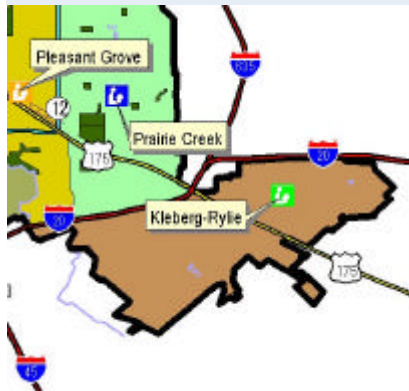

Kleberg-Rylie Service Area

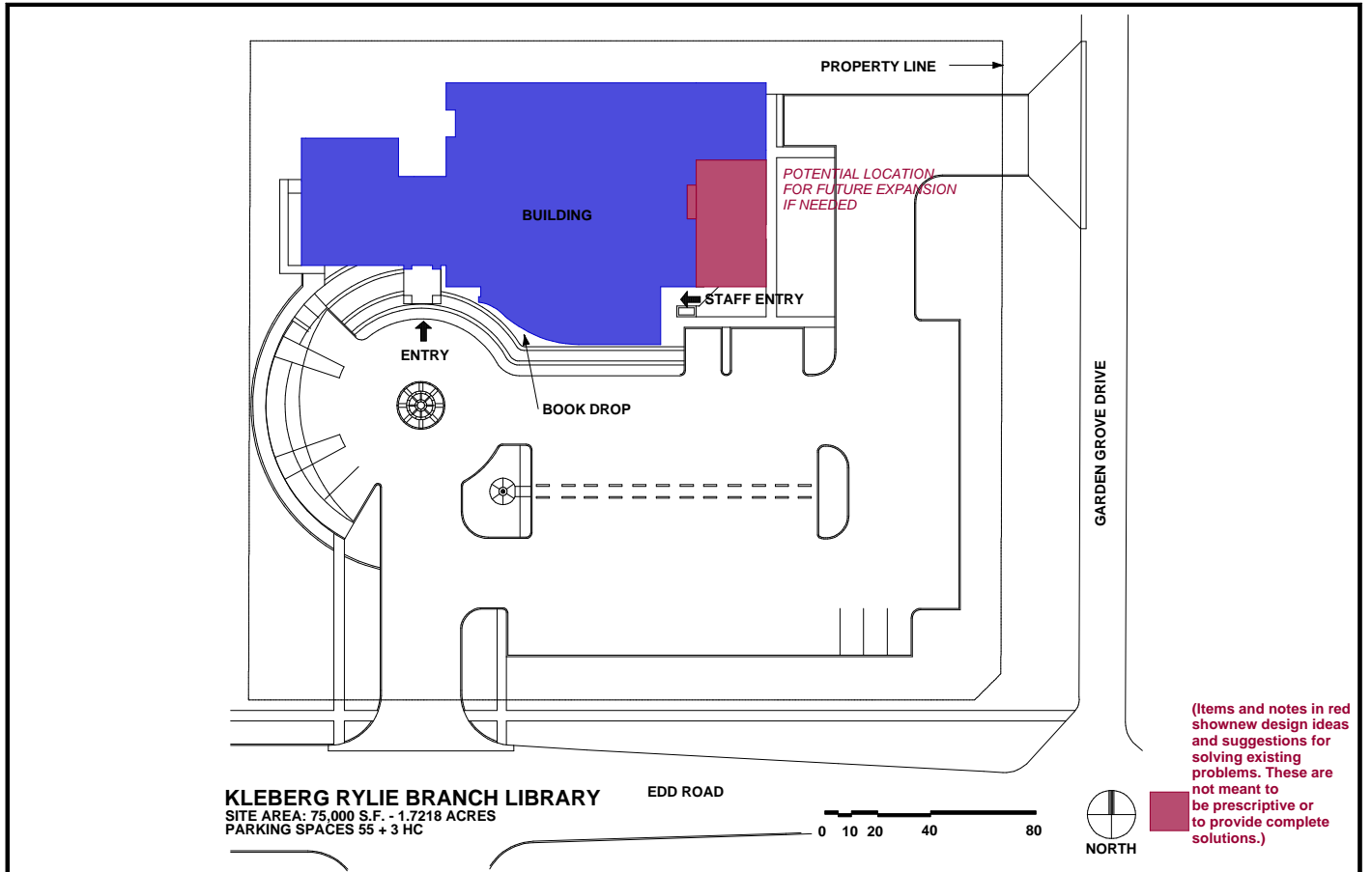

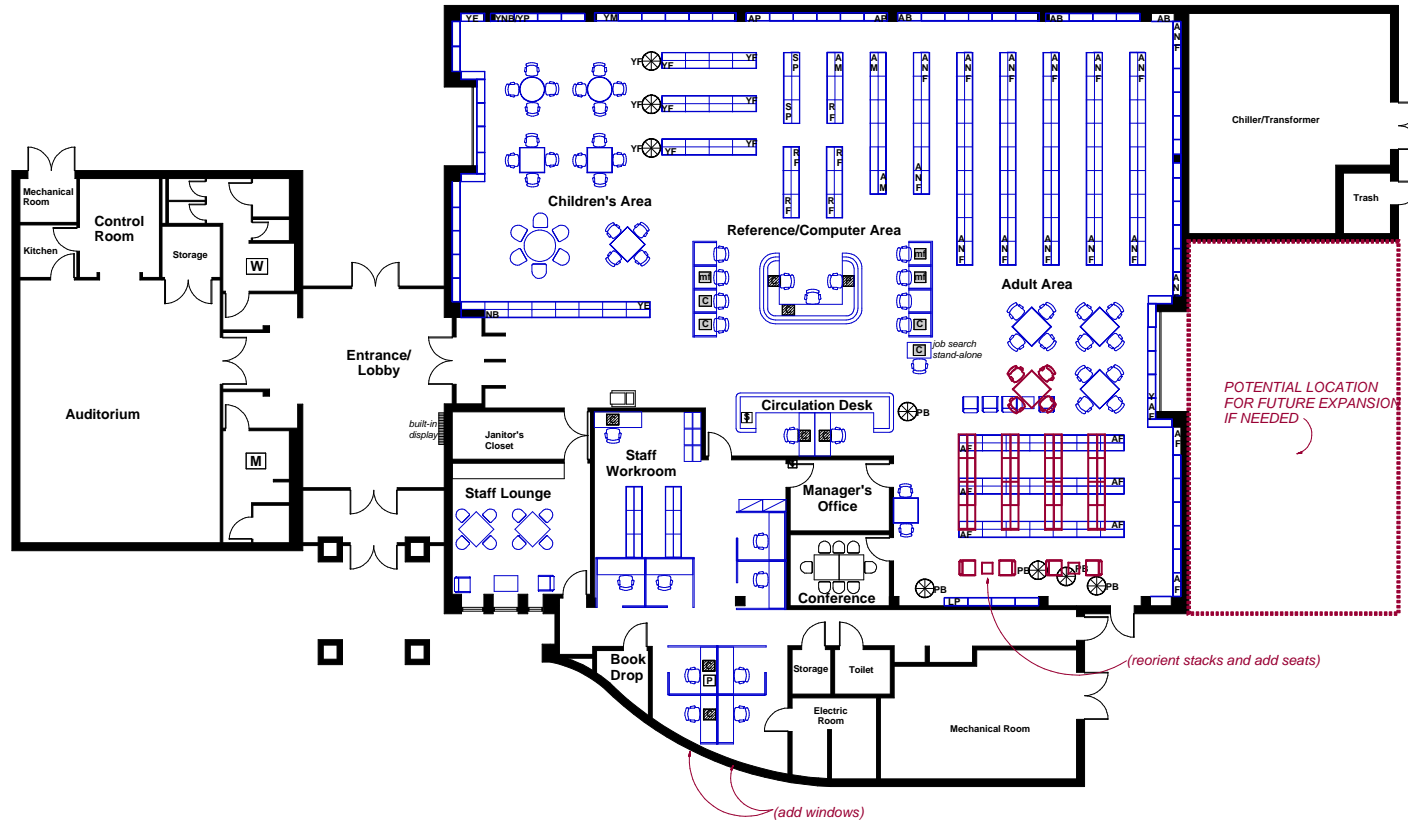

(Items and notes in red show new design ideas and suggestions for solving existing problems. These are not meant to be prescriptive or to provide complete solutions.)

# KLEBERG-RYLIE BRANCH LIBRARY

## Existing Floor Plan

### LEGEND

- HIGH SHELVING (5 TO 7 SHELVES)
- LOW SHELVING (3 OR 4 SHELVES)
- DISPLAY SPINNERS (5 TO 7 SHELVES)
- BOOK BIN
- COMPUTER WORKSTATION - PUBLIC
- COMPUTER WORKSTATION - STAFF
- MICROFORM WORKSTATION
- PHOTOCOPIER
- DISPLAY TABLE
- ATLAS TABLE
- CASH REGISTER
- PRINTER
- WOMEN'S ROOM
- MEN'S ROOM

### CHILDREN'S COLLECTION SHELVING

- YE Youth Easy Books & Picture Books
- YF Youth Fiction
- YNF Youth Non-fiction
- YB Youth Biography
- YAF Young-Adult Fiction (Sci-Fi, Mystery)
- YPB Youth Paperbacks
- YP Youth Periodicals
- YM Youth Media
- YNB Youth New Books
- YH Youth Holiday Books

### ADULT COLLECTION SHELVING

- AF Adult Fiction (Sci-Fi, Mystery)
- ANF Adult Non-Fiction
- AB Adult Biography
- AP Adult Periodicals
- AS Adult Special Collection
- AM Adult Media
- LP Large Print
- SP Spanish Language
- PB Paperbacks
- NB New Books

### OTHER SHELVING

- RF Reference Collection
- STF Staff Shelving
- OS Over-sized shelving

## KLEBERG RYLIE BRANCH LIBRARY



# KLEBERG-RYLIE BRANCH LIBRARY

## Building Infrastructure: Assessments & Recommendations

### ASSESSMENTS

#### SITE/LANDSCAPE

Better landscaping needed. Some trees are dying. Ground cover has minimal irrigation. Message sign is inappropriate style.

#### STRUCTURE

No structural deficiencies were observed.

#### ROOF & INSULATION

Roofing systems are relatively new and appear in good condition., yet a roof leak was reported by staff. A loose flashing anchor strip was observed and reported to the library.

#### EXTERIOR WALLS

The exterior brick is generally in good condition. Removal of graffiti in areas has caused discoloring of the finish. There are signs of efflorescence in the brick below the cast stone band that runs along the upper wall, indicating some water penetration at this level.

#### EXTERIOR DOORS & WINDOWS

The existing storefront sytem and hollow metal doors are in good condition.

#### INTERIOR FINISHES

Overall, the interior finishes are in good condition.

#### ACCESSIBILITY

The kitchen cabinet at the sink is not ADA compliant.

#### MECHANICAL AND ELECTRICAL SYSTEMS

Since Kleberg-Rylie Branch library was completed in 1995 and no significant problems have been reported, an assessment is not necessary at this time.

### RECOMMENDATIONS

#### SITE/LANDSCAPE

Review landscape plans and provide enhancements and better maintenance (i.e. irrigation) of existing plants. Redesign sign graphics.

#### STRUCTURE

No action required.

#### ROOF & INSULATION

Investigate roof leak and repair. Re-attach flashing anchor strip

#### EXTERIOR WALLS

Clean masonry. Investigate for causes of efflorescence at upper wall. Recommend perimeter building/ site lighting with motion detection sensors, to discourage vandals.

#### EXTERIOR DOORS & WINDOWS

Clean and repair windows and doors as necessary (i.e. hall door)

#### INTERIOR FINISHES

Patch portion of east vaulted drywall ceiling finish to match existing.

#### ACCESSIBILITY

Modify kitchen cabinet at sink to comply with ADA accessibility criteria.

**KLEBERG-RYLIE  
BRANCH LIBRARY  
Planning and Design  
Assessments  
& Recommendations**



View of the circulation desk



View of the reading room

*ACTION PLAN*

This new branch is in excellent physical condition. At 10,700 SF, this library adequately serves a low density and large service area and possesses additional capacity for population growth.

**MAINTAIN  
the library and  
the present size and  
boundaries of the  
service area.**

1999 POPULATION: 12,788  
2009 POPULATION: 18,072  
(service boundaries unchanged)

**PROJECTED  
OPERATING EXPENSE  
Kleberg-Rylie Branch:  
\$332,856**

**ASSESSMENTS**

- PARKING**
  - The parking lot could use more landscaping. The lot is not visible from within the building.
- ENTRANCE**
  - The exterior axial entry could be accented with display banners..
- CIRCULATION DESK**
  - The desk is recessed from the entry line of sight, and is remote from entry.
- AUDITORIUM**
  - The meeting room is small, but can be used independent of the library hours of operation.
- DISPLAYS**
  - The displays are small and not very eye-catching.
- ADULT AREA**
  - There is insufficient seating for adults.
- CHILDREN'S AREA**
  - The circulation desk could be bypassed as one exits this area.
- STAFF AREA**
  - Added windows could improve monitoring and security of the reading room.
- GROUP STUDY/CONFERENCE**
  - One study/conference room is provided.
- SERVICE DESKS**
  - Seating is needed adjacent to the reference desk.
- FURNITURE**
  - There is a lack of variety in seating types (i.e. quiet alcove vs. grouped tables.)
- BUILDING EXTERIOR**
  - The "Civic image" from the drive and parking lot is not very inviting due to very limited glazing.

**RECOMMENDATIONS**

- PARKING**
  - Add windows at the office area.
- ENTRANCE**
  - Add display banners
- CIRCULATION DESK**
  - Adjust the design of the desk to increase visibility and proximity to the entrance.
- AUDITORIUM**
  - No action required.
- DISPLAYS**
  - The library should consider new interactive display units and bold wall graphics.
- ADULT AREA**
  - Adjust the current plan to accept additional adult seating (4 to 6 seats).
- CHILDREN'S AREA**
  - See note regarding the location of the circulation desk above.
- STAFF AREA**
  - Add windows to improve monitoring and security of the reading room.
- GROUP STUDY/CONFERENCE**
  - No action required.
- SERVICE DESKS**
  - Redesign reference desk area to make room for seating.
- FURNITURE**
  - Increase the variety of seating choices in the branch.
- BUILDING EXTERIOR**
  - Exterior banners and new windows could help the library look more inviting from the exterior.